

ROYAL GT[®]

Small-Body Rear Loader



"The Royal GT works great in narrow alleys!"

The Royal GT features mid-compaction ratings, fast packing and low maintenance.

Designed as a larger version of the Super Series, the Royal GT features a curved floor combined with a curved body, providing excellent compaction in a lightweight unit that can go virtually anywhere. A full range of container and cart handling options are available.

Standard Features:

- 10 to 16 cu. yd. capacities
- high-strength, curved shell body design
- mid-compaction ratings ensure full chassis GVW capacity
- low loading height for greater operator convenience
- automatic locking tailgate for safer use
- some models CDL and FET exempt



ANSI lighting standard with optional lighting available



Body-mounted hydraulic reservoir and filter assembly



Optional roll bar for commercial collection

WAYNE[®]
ENGINEERED FOR PERFORMANCE
www.WayneUSA.com

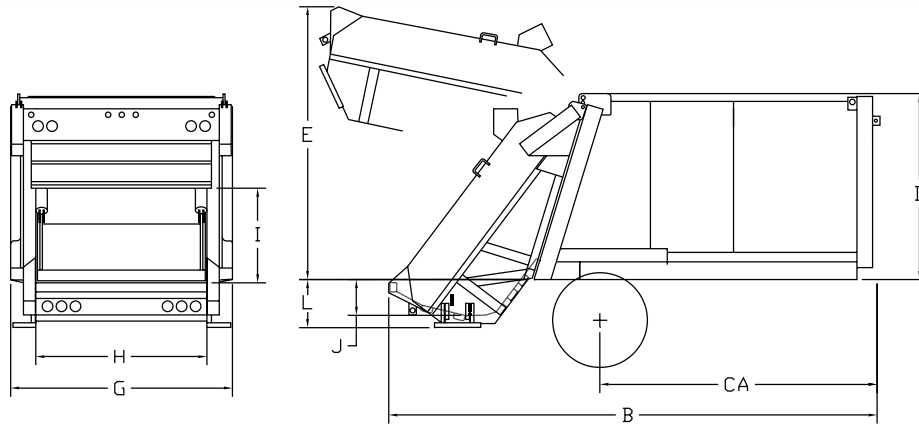

BODY SPECIFICATIONS

	GT10	GT11	GT12	GT14	GT16
Advertised Body Size	10 cu. yd.	11 cu. yd.	12 cu. yd.	14 cu. yd.	16 cu. yd.
B: Overall Length	173"	197"	197"	209"	227"
CA: To Centerline of Rear Axle	84"	108"	108"	120"	138"
D: Height Above Chassis Frame	80"	80"	80"	80"	80"
E: Height Above Chassis Frame – Tailgate Raised	120"	120"	120"	120"	120"
F: Body — Outside Width	96"	84"	96"	96"	96"
G: Hopper Opening Width	74"	62"	74"	74"	74"
H: Hopper Opening Height	78"	78"	78"	78"	78"
I: Hopper Depth	13"	13"	13"	13"	13"
J: Hopper Bottom Below Chassis Frame	20"	20"	20"	20"	20"
K: Top of Step Below Chassis Frame	adjustable				
L: Loading Sill Above Chassis Frame	2"	2"	2"	2"	2"
Dynamic Hopper Capacity (cu. yd./min)	6 cu. yd.	5 cu. yd.	6 cu. yd.	6 cu. yd.	6 cu. yd.
Hopper Capacity	2 cu. yd.	1.5 cu. yd.	2 cu. yd.	2 cu. yd.	2 cu. yd.
Center of Gravity Measured From Front of Body					
• Body Only	78"	101"	104"	106"	114"
• Pay Load	67"	81"	79"	85"	94"
Approx. Body Weight	7,850 lbs.	7,700 lbs.	8,000 lbs.	8,150 lbs.	8,450 lbs.
Truck GVWR Recommended	24,000 lbs.	25,000 lbs.	25,900 lbs.	28,000 lbs.	31,000 lbs.

Features

- High-strength, curved shell body design for optimum strength-to-weight ratio
- 20-second packing cycle time
- Proven, worldwide performance
- Low loading height
- Automatic latching tailgate
- CDL & FET exempt

Body Construction

- Sides — 11 gauge 50,000 PSI
- Top — 11 gauge 50,000 PSI
- Floor — 11 gauge 50,000 PSI

Tailgate Construction

- Hopper sides — 8 gauge 50,000 PSI
- Hopper bottom — 3/16" AR400 177,000 PSI
- Side panel — 7 gauge 50,000 PSI
- Sweep panel — 3/16" AR400 177,000 PSI

Hydraulic System

Cylinders:

- (2) 4.5" double-acting packer panel cylinders
- (2) 3.5" double-acting slide cylinders
- (1) 4.5" double-acting ejection cylinder (GT16 – 5.5"), telescopic
- (2) 3.5" single-acting tailgate lift cylinders

Pump — Gear Type:

- Capacity — 21 GPM @ 1,500 RPM
- Maximum operating pressure — 2,100 PSI

Hydraulic Tank:

- Capacity — 20 gal.
- Location — Right-hand front on floor inside body
- Sight Gauge — on tank
- Filter — 10 micron return line filter with by-pass valve

Optional Equipment

- Strobe light or rotating beacon
- Hydraulically operated roll bar
- 8,000 lb. drum winch
- Side access door
- Cart tipper
- Work lights

WAYNE®
ENGINEERED FOR PERFORMANCE

701 Performance Drive, Cedar Falls, IA 50613
Phone: (319) 266-1721 • Fax: (319) 266-8207

Tollfree: (877) 889-2963
www.WayneUSA.com